

Eden Park Avenue

£335,000



A three bedroom family home, located in the Langley Schools Catchment.

The entrance hall comprises of two reception rooms and a kitchen.

The first floor comprises of three bedrooms and a family bathroom. The property also benefits from a garage to the rear and gas central heating.

The property is offered chain free.

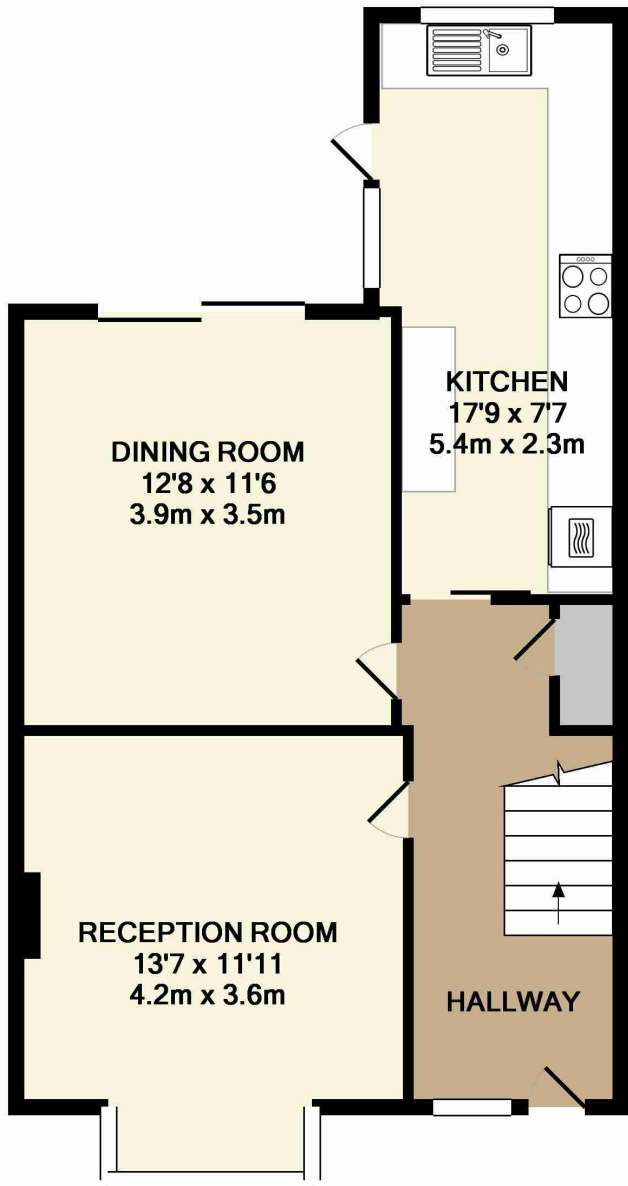

GROUND FLOOR

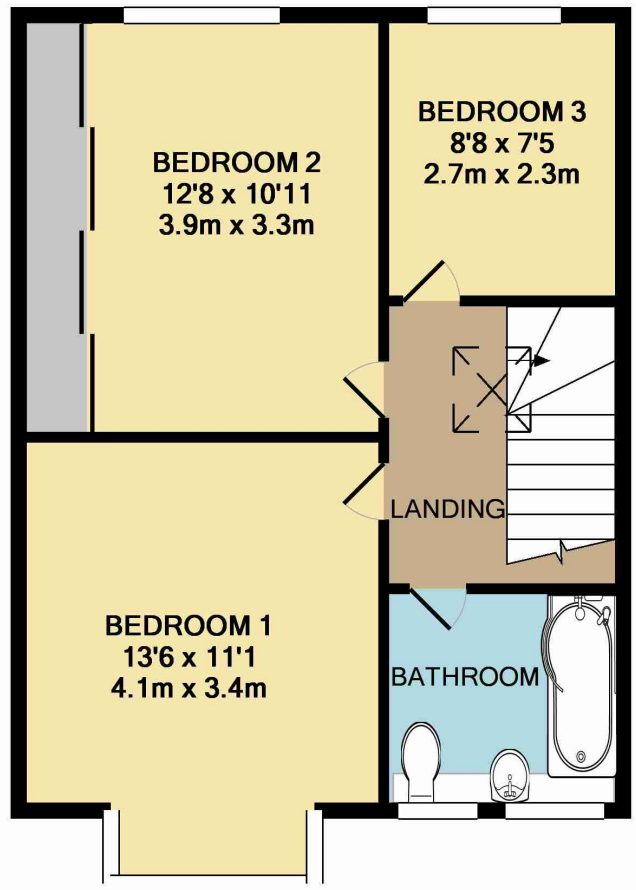

1ST FLOOR

TOTAL APPROX. FLOOR AREA 1012 SQ.FT. (94.0 SQ.M.)

Whilst every attempt has been made to ensure the accuracy of the floor plan contained here, measurements of doors, windows, rooms and any other items are approximate and no responsibility is taken for any error, omission, or mis-statement. This plan is for illustrative purposes only and should be used as such by any prospective purchaser. The services, systems and appliances shown have not been tested and no guarantee as to their operability or efficiency can be given

Made with Metropix ©2012

Disclaimer: Please note these particulars whilst

believe to be accurate are set out as guidelines

only and do not constitute any part of an offer

or contract.

Energy Efficiency Rating		Environmental Impact (CO ₂) Rating	
	Current	Potential	
Very energy efficient - lower running costs (92-100) A			Very environmentally friendly - lower CO ₂ emissions (92-100) A
(81-91) B		86	(81-91) B
(69-80) C			(69-80) C
(55-68) D	67		(55-68) D
(39-54) E			(39-54) E
(21-38) F			(21-38) F
(1-20) G			(1-20) G
Not energy efficient - higher running costs			Not environmentally friendly - higher CO ₂ emissions
England & Wales	EU Directive 2002/91/EC		England & Wales
			EU Directive 2002/91/EC

The energy efficiency rating is a measure of the overall efficiency of a home. The higher the rating the more energy efficient the home is and the lower the fuel bills will be.

The environmental impact rating is a measure of a home's impact on the environment in terms of carbon dioxide (CO₂) emissions. The higher the rating the less impact it has on the environment.