

UPPER ELMERS END ROAD, BR3 £399,999



langleyestateagents.co.uk
408 Upper Elmers End Road
Beckenham Kent BR3 3HG
0208 166 0400
office@langleyestateagents.co.uk



Langley Estate Agents are please to offer a three bedroom house situated in an ideal location for Langley Secondary School, Eden Park Train Station and local amenities.

The property comprises of two reception rooms, and a kitchen.

The first floor comprises of three bedrooms and a bathroom.

The property also benefits from a lovely rear garden and a garage at the rear with an access road.

CALL US ON 0208 166 0400



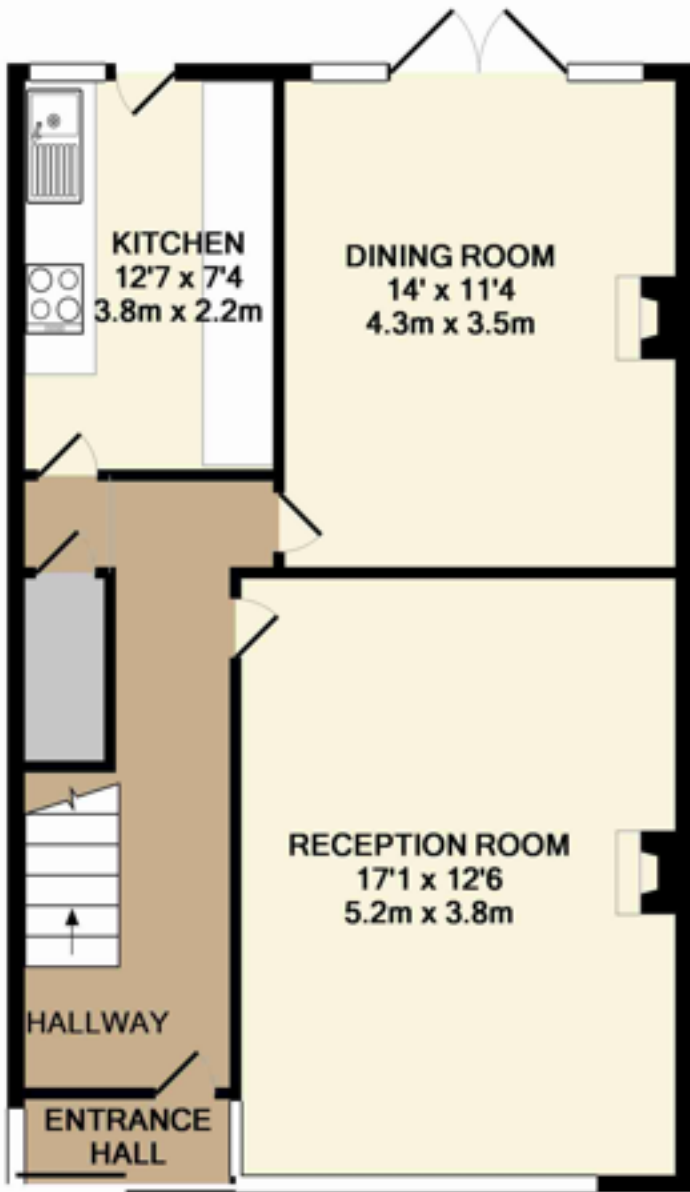

GROUND FLOOR

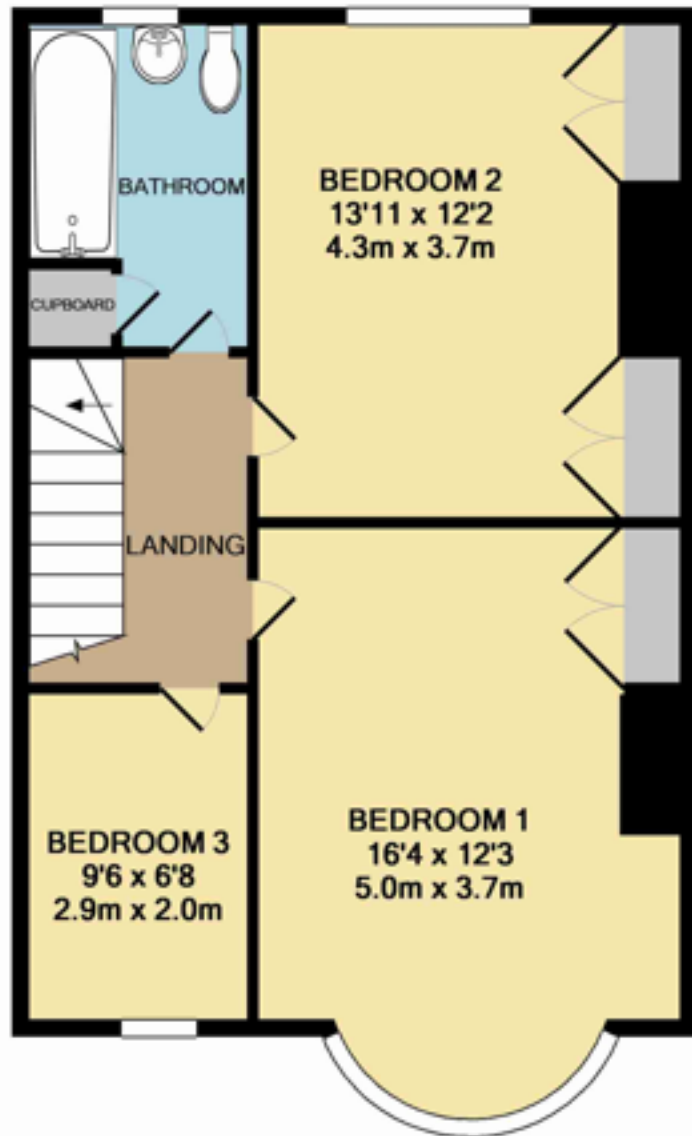

1ST FLOOR

TOTAL APPROX. FLOOR AREA 1152 SQ.FT. (107.0 SQ.M.)

Whilst every attempt has been made to ensure the accuracy of the floor plan contained here, measurements of doors, windows, rooms and any other items are approximate and no responsibility is taken for any error, omission, or mis-statement. This plan is for illustrative purposes only and should be used as such by any prospective purchaser. The services, systems and appliances shown have not been tested and no guarantee as to their operability or efficiency can be given

Made with Metropix ©2015



These particulars have been prepared in good faith to give a fair overall view of the property; they do not constitute an offer and will not form part of any contract. We make no representation about the conditions of the property nor that any services or appliances are in good working order; this should be checked by your surveyor. Furthermore, you should not assume that any items or features referred to in these particulars or shown in the photographs are included in the sale price. Your solicitor should check this as part of the normal conveyancing process.

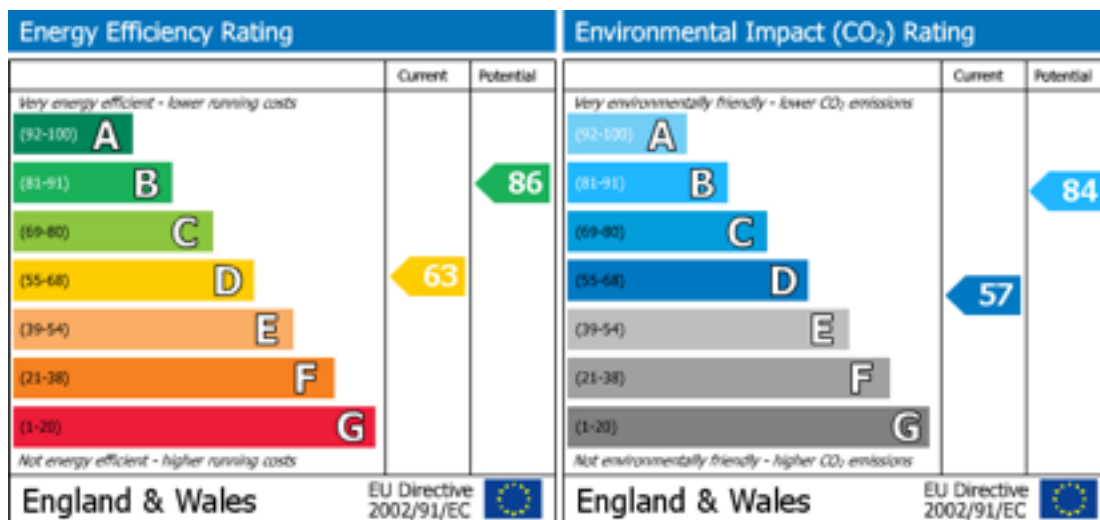

The energy efficiency rating is a measure of the overall efficiency of a home. The higher the rating the more energy efficient the home is and the lower the fuel bills will be.

The environmental impact rating is a measure of a home's impact on the environment in terms of carbon dioxide (CO₂) emissions. The higher the rating the less impact it has on the environment.

